

---

# QUICK START GUIDE

---



## OPTIMA PLUS-SOFT PLUS



OPTIMA SOFT PLUS



OPTIMA PLUS

## MACHINE DESCRIPTION



### LEGEND

- 1 COFFEE HOPPER
- 2 DECAFFEINATED DOOR
- 3 CARD READER
- 4 PEOPLE PRESENCE SENSOR
- 5 RUBBER PROTECTION
- 6 DISPLAY TOUCH
- 7 HOT WATER DISPENSER
- 8 DOOR LOCK
- 9 STEAM WAND
- 10 ADJUSTABLE COFFEE DISPENSER
- 11 DRIP TRAY
- 12 GROUNDS BIN

*Only for US market (ETL Sanitation): The equipment shall be installed with backflow protection to comply with applicable federal, state and local codes.*

## STARTING UP

Open the machine front door and power the machine ON by means of the main switch inside the machine  
Afterwards check that the machine door is closed and the ground bin and the drip tray are inserted

Press ON to turn the machine ON.



When the boiler temperature of 50°C (122°F) is reached, the machine carries out a group rinsing  
When the set-up temperature is reached, the display shows:



To switch OFF the machine press INFO ⓘ, then press Switch off the machine

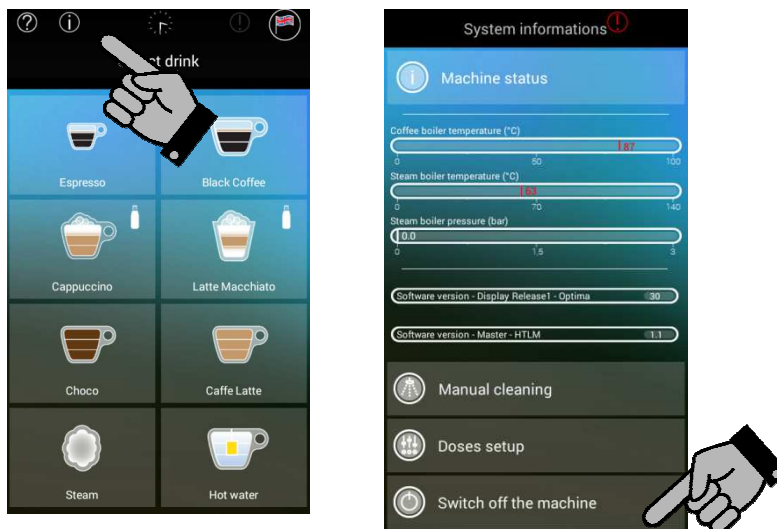

## FILL IN BEAN HOPPER AND CANISTER

Fill in the required amount for daily consumption in order to keep coffee and product always fresh



## DISPENSING

### 1) COFFEE/CAPPUCCINO/CHOCO DISPENSING

Adjust the dispenser to the correct height and place a cup under it, then press the touch screen on the desired dose.

For SHIFT doses, swipe to the next page touching the touch screen from right to left.

For WAITERS' CARD place the smart card above the proper reader before pressing the dose key.

The display shows:

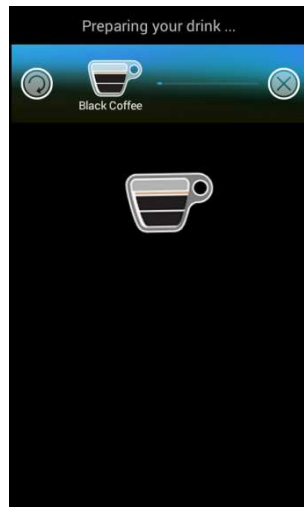

#### PLEASE NOTE:

- Press  during dispensing to stop the selected dose (not available for Self configuration)
- The cursor indicates the amount of drink being dispensed.

### 2) HOT WATER DISPENSING

Place a cup under the hot water outlet, and press the hot water dose key. Dispensing will be automatically stopped once the programmed dose is over. The display shows:

For WAITERS' CARD place the smart card above the proper reader before pressing the dose key.

The display shows:

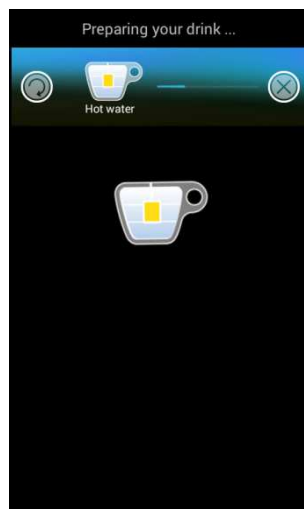

#### PLEASE NOTE:

- Press  during dispensing to stop the selected dose (not available for Self configuration)
- The cursor indicates the amount of drink being dispensed.
- Hot water cannot be dispensed simultaneously with steam

### 3) DECAFFEINATED DISPENSING (NOT AVAILABLE FOR SELF CONFIGURATION)

Adjust the dispenser to the correct height and place a cup under it, then open the decaffeinated coffee door, the display shows :



- Pour in the powdered coffee
- Close the decaffeinated door
- Press the touch screen on the desired dose. The selected dose will be dispensed without the activation of the grinders. The display shows:

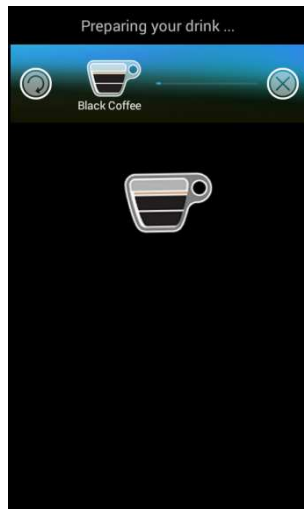



#### PLEASE NOTE:

- Press  during dispensing to stop the selected dose
- The cursor indicates the amount of drink being dispensed
- If the decaffeinated door is not closed, or if the dose button is not selected, the machine will automatically cancel this function after 20 seconds. The coffee group will carry out a cleaning cycle of the brewing chamber.

### 4) EXTRAMILK DISPENSING (ONLY LM MACHINE, NOT AVAILABLE FOR SELF CONFIGURATION)

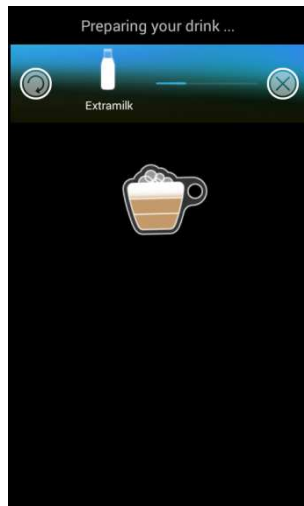
Press and keep pressed any milk-based key having the little bottle icon , after 2 seconds foamed or steamed milk will start being dispensed, the display shows:



Press  to stop the dispensing

## STEAM WAND USE AND CLEANING

### STEAM WAND NOT AVAILABLE FOR MACHINE IN SELF CONFIGURATION

1► Before using the steam wand press the steam key to purge the nozzle



2► Use the steam wand to foam or heat any liquid into the jug by handling the rubber protection

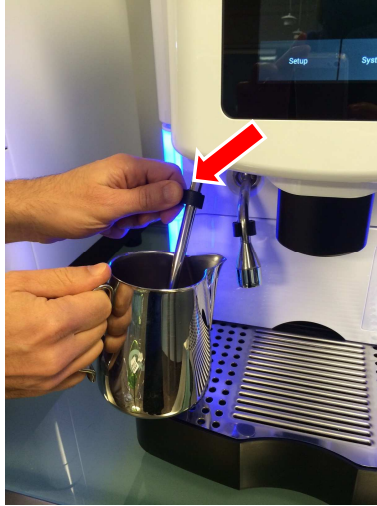

3► Press the steam button to stop the delivery before removing the jug

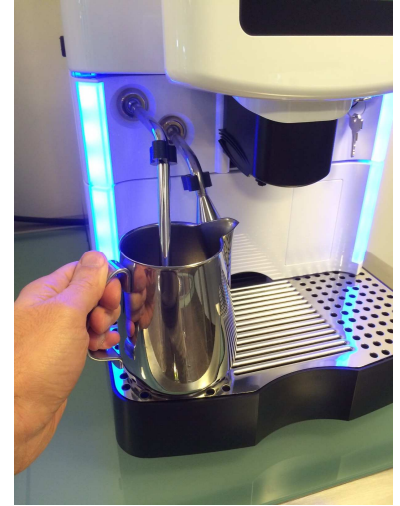

4► After using the steam wand press the steam key to purge the nozzle



5► Clean the steam wand by means of a cloth



6► **DO NOT** leave the steam wand into any liquid at any time

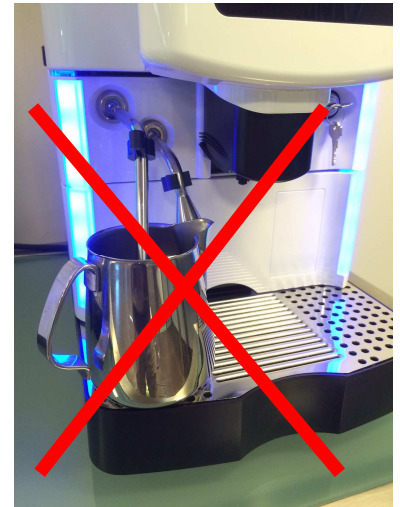

**WE STRONGLY RECOMMEND TO USE AND CLEAN THE STEAM WAND AS ABOVE SHOWN**

# POWER CLEANER

**DURING WORKING DAY, IF MACHINE LAYS IN STAND-BY WITHOUT DISPENSING MILK BASED DRINKS,  
WE STRONGLY RECOMMEND TO CARRY OUT POWER CLEANER**

1► Press INFO button

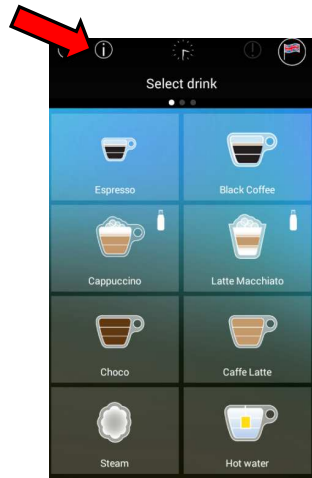

2► Press Manual Cleaning



3► Press START next to Power Cleaner to confirm

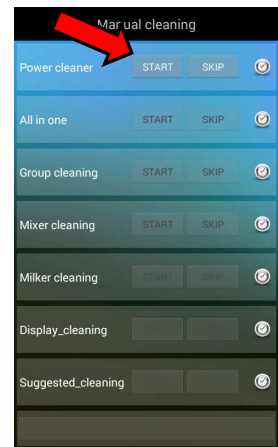

4► Insert the black pipe support in the drip tray grid and press NEXT to confirm

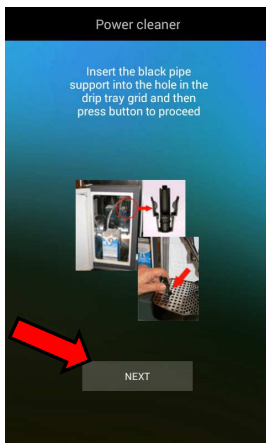

5► Insert the silicone tube into the black pipe support and press NEXT to confirm

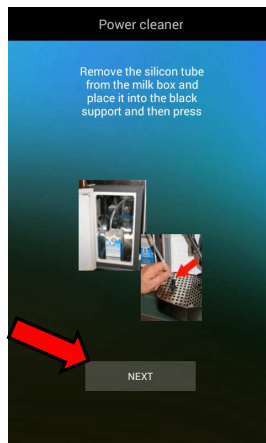

6► Wait the end of the Power Cleaner. Afterwards the machine exits the cleaning menu and it will be ready to dispense drinks

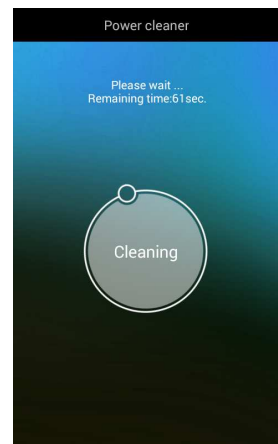

7► Once the Power Cleaner is finished the display shows





# AUTOMATIC CLEANING OF COFFEE GROUP - MIXER - MILK FROTHER - STEAM BOILER

**AT THE END OF EACH WORKING DAY , AND/OR IN CASE THE MACHINE WILL NOT BE USED SOME TIME, WE STRONGLY RECOMMEND TO CARRY OUT AUTOMATIC CLEANING OF THE COFFEE GROUP ,THE MIXER AND THE MILK FROTHER**

**1► Press INFO button**



**2► Press Manual Cleaning**

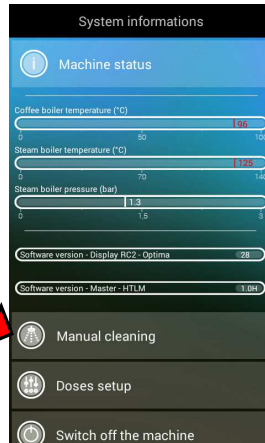

**3► Press SKIP next to Power Cleaner**

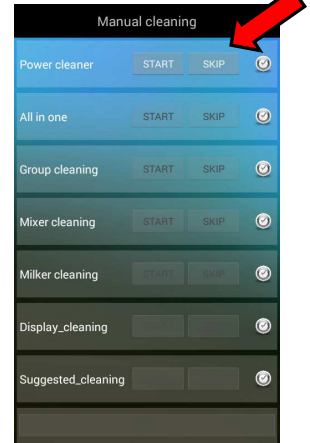

**4► Press START next to All in one**

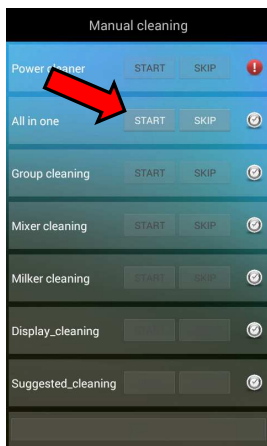

**5► Press YES or NO depending if you want the machine automatically to switch OFF or not at the end of the cleaning cycle**

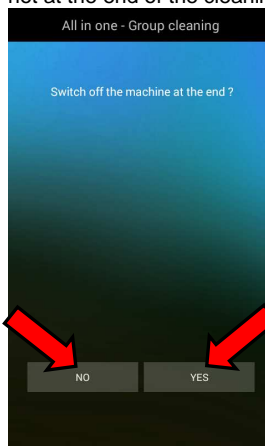

**6► Press YES or NO depending if you want the machine automatically to switch OFF or not at the end of the cleaning cycle**

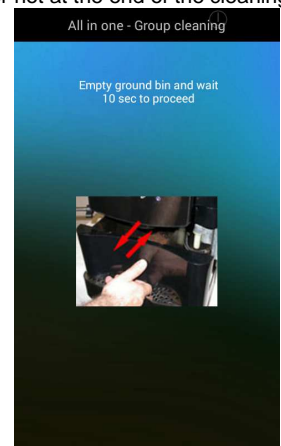

**7► Lift the coffee outlets completely**

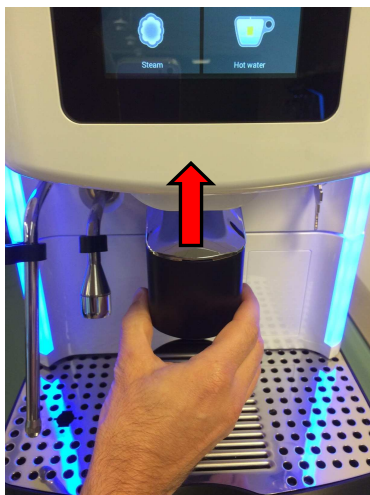

**8► Remove and empty the grounds bin**

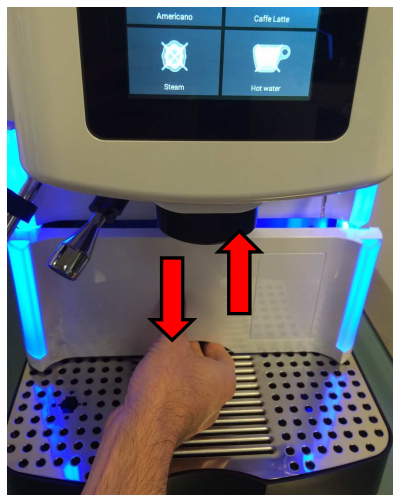

**9► Clean the grounds bin compartment.**

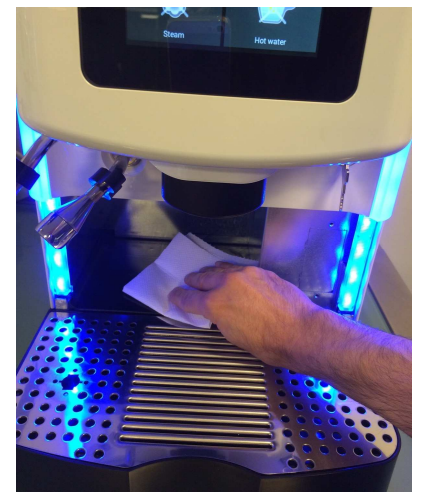

**10►** Remove and empty also the drip tray. Only for machines without direct water discharge

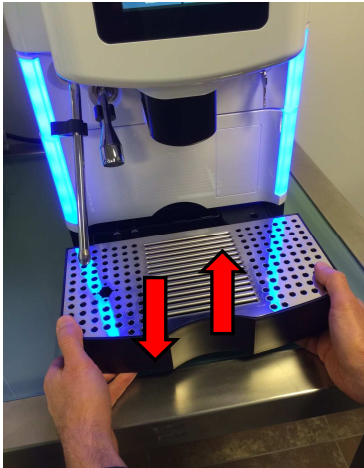

**11►** Insert cleaning solution into an empty container having at least 500ml size. Take the milk feeding tube out of the milk box, then insert it into the container with detergent

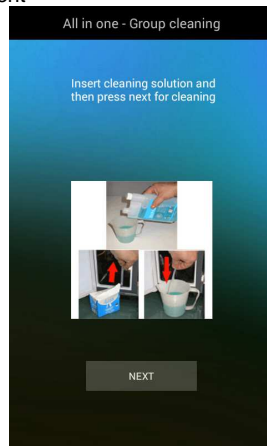

**12►** Open the machine door

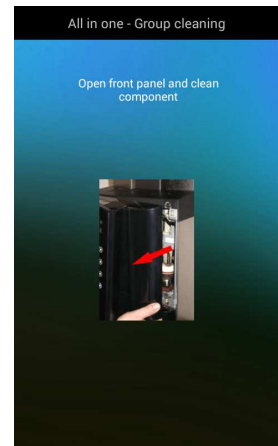

**13►** Clean the group from any coffee residues, then close the machine door

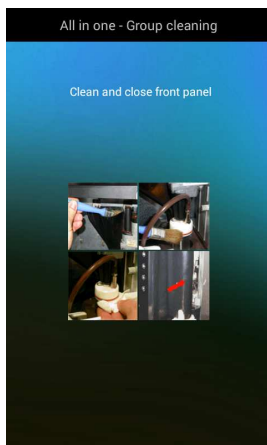

**14►** Open the machine door insert the detergent tablet into the brewing chamber

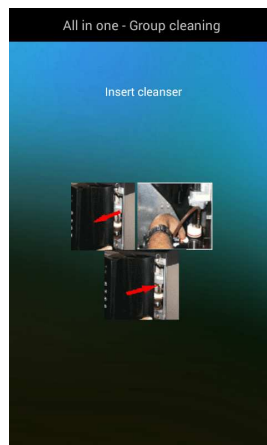

**15►** Wait the group cleaning ends, afterwards the machine will carry out mixer and milker cleaning cycles if present

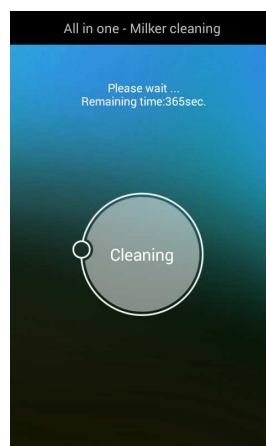
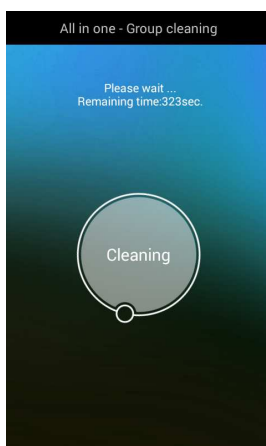

**16►** Once the cleaning cycles are finished the display shows select drink page or the machine switches OFF, depending to your selection previously made

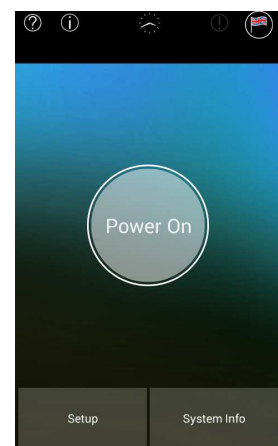

**PLEASE NOTE:**

- a) Do not interrupt the cleaning cycle. If the cleaning cycle is interrupted by any type of operation unrelated to the procedure, when the machine functioning is set back again, the cleaning cycle will automatically be activated.
- b) Only in case that after the automatic cleaning process of the coffee outlet or the milk frother are not properly dispensing, carry out a manual cleaning; see the following steps.

**FOR CLEANING OPERATIONS, CARIMALI STRONGLY RECOMMEND TO USE THE FOLLOWING DETERGENT PRODUCTS:**

**GROUP CLEANING TABLETS**

**MILK FROTHER CLEANER**



**MANUAL CLEANING OF MILK FROTHER AND COFFEE OUTLET**

3

**1►** Open the machine door and remove the coffee outlet cover .

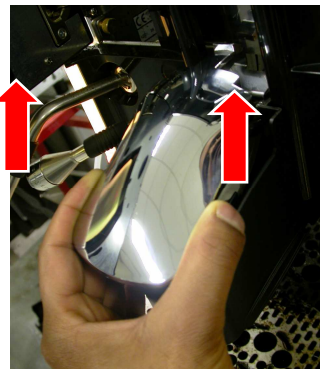

**2►** Remove the coffee outlet from its holder.



**3►** Remove the milk frother from the coffee outlet and disconnect Silicone tubes No. -3- and -4-.

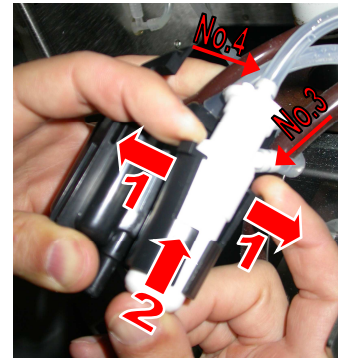

**4►** Disassemble the milk frother in all its parts (first by turning and then by pulling as shown in the picture) and wash it either by hand or in a dishwasher. Make sure that all the holes are free from milk residues and also to use provided tools to clean the holes. Check also that the O-rings are in good condition

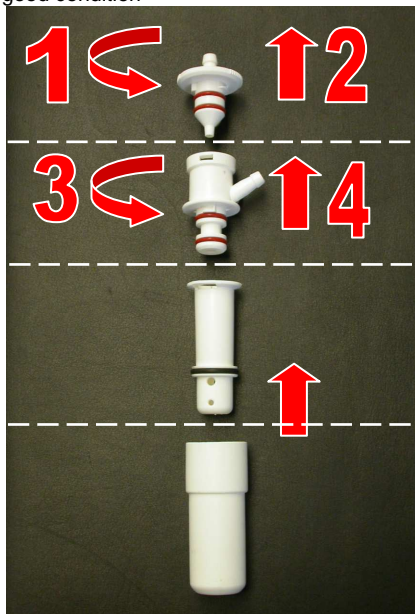

**5►** Disassemble the coffee outlet (1) and wash it by hand or in a dishwasher. Make sure that all the holes are free from any coffee residues , and also to use provided tools to clean the holes.

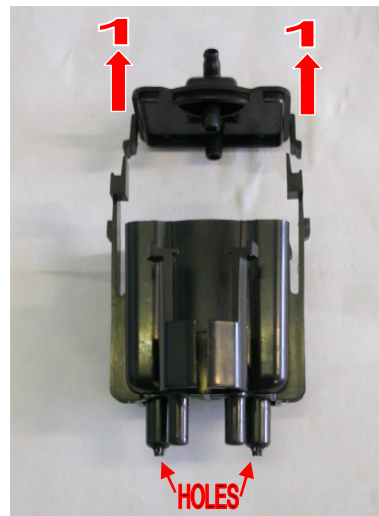

**MANUAL CLEANING OF MIXER - ONLY FOR MACHINE WITH INSTANT PRODUCT UNIT**

**WE STRONGLY RECOMMEND CLEANING THE MIXERS ONCE A DAY**

1► Open the dispenser unit door



2► Remove the pipe from the mixer



3► Turn the flange 1 anticlockwise, then remove the mixer 2



4► Remove the Decanter



5► Rinse the Mixer and the Decanter in a sink



6► Reinsert the Decanter



7► Turn the flange clockwise to reinsert the mixer



8► Reinsert the pipe from the mixer

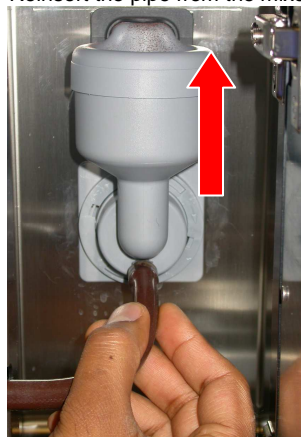

## OTHER RECOMMENDED CLEANING

### DRIP TRAY CLEANING

Once a day rinse the drip tray in a sink.



### GROUNDS BIN CLEANING

Once a day rinse the grounds bin in a sink.



### HOPPER CLEANING

Once a week clean the hopper by means of a cloth and approved food detergent



## CHUTES CLEANING

1► Open the decaffeinated door and remove the chute .



2► Once a week clean the decaffeinated chute by means of a brush and approved food detergent



3► Once a week clean the coffee chute by means of a brush and approved food detergent



## DISPENSER CLEANING ONLY FOR MACHINE WITH INSTANT PRODUCT UNIT

1► Open the dispenser unit door.



2► Press the plastic tooth inside ( 1 )

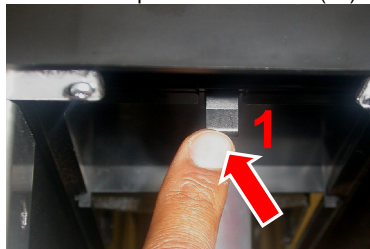

3► Remove the plastic cover ( 2 )



4► Remove the canister



5► Once a week clean the dispenser by means of a cloth and approved food detergent



## MILK FROTHER ADJUSTMENT

### FOAM SETTING

The milk frother is equipped with a FOAM REGULATOR which sets the quantity of air needed to froth milk. Open the machine door turn the ring nut clockwise for thicker foam (small bubbles), or turn it anticlockwise for more voluminous foam (large bubbles) then lock it with the locknut.

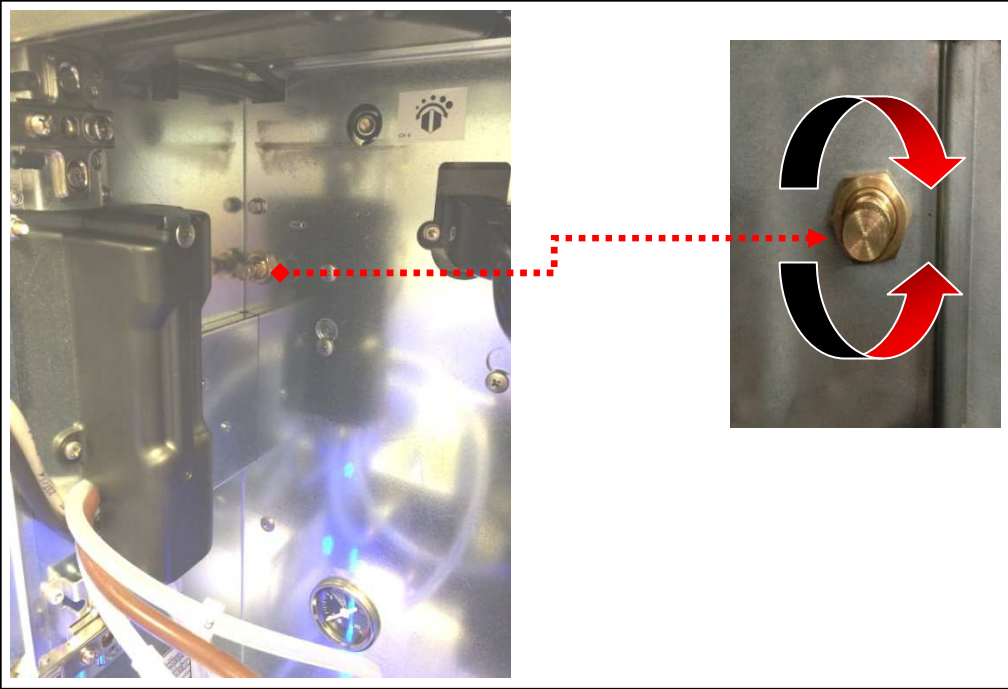

### MILK TEMPERATURE SETTING (ONLY FOR MACHINE WITHOUT MTT)

The milk frother is equipped with a MILK TEMPERATURE REGULATOR which reduces the quantity of sucked milk. Turn the regulator clockwise to increase the milk temperature, or turn it anticlockwise to reduce it.

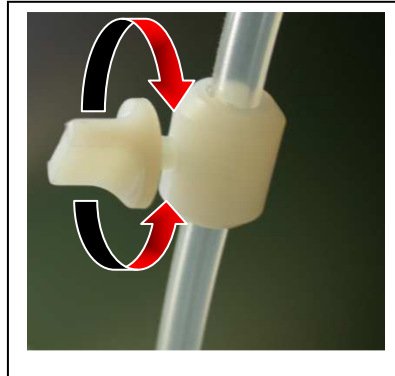

## MACHINE FUNCTIONS MESSAGES

- 1) OPEN DOOR
- 2) GROUNDS BIN FULL
- 3) MISSING COFFEE
- 4) MISSING DECAFFEINATED
- 5) DRIP TRAY NOT IN POSITION
- 6) DRIP TRAY FULL

IN CASE OF ONE OF THE ABOVE MESSAGES, THE ⓘ BUTTON LIGHTS UP RED AND A THE MESSAGE IS SHOWN NEXT TO IT

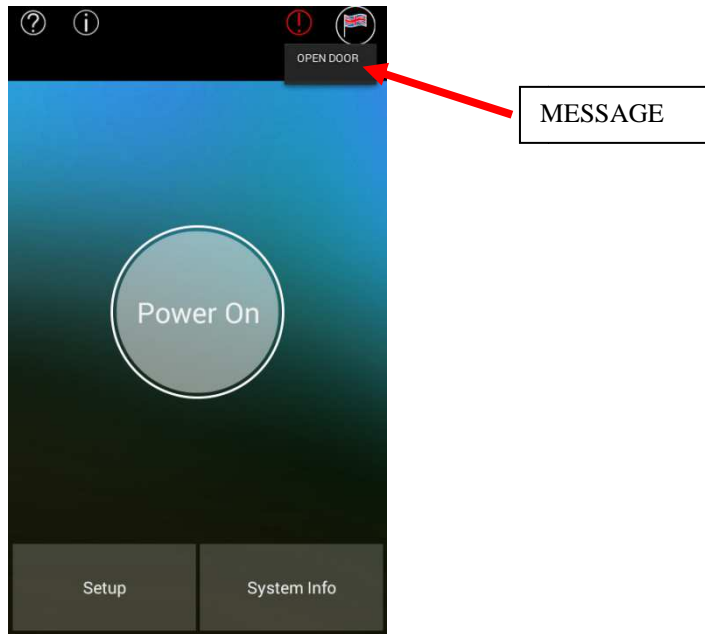

IN CASE OF ANY SHUT DOWN ALARM PLEASE REFER TO YOUR SERVICE CENTER

## ACCESS THE MAIN SETTING MENUS WITH PASSWORD OR SMART-CARD

### A) ACCESS THE MAIN SETTING MENUS WITH PASSWORD

To enter the programming environments, a password is required which define the access rights to the different environments. The password must be composed with 5 numbers.

To insert the passwords proceed as follows:

- 1) Turn the machine OFF
- 2) Press SETUP button; the display shows:



- 3) Enter one of the following passwords:
  - WAITER 6 1 1 1 1
  - OWNER 2 2 2 2 2

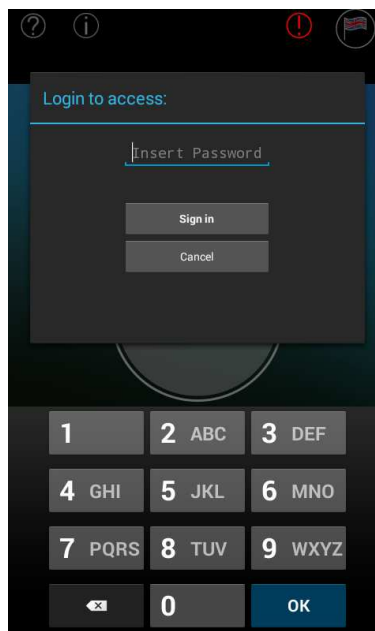



After having inserted the password, the display shows the main menu programming environments:

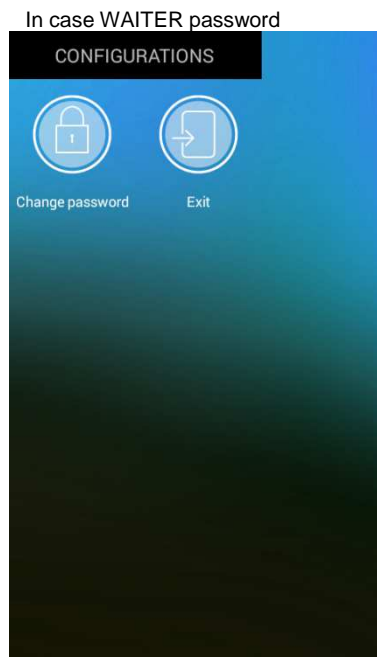
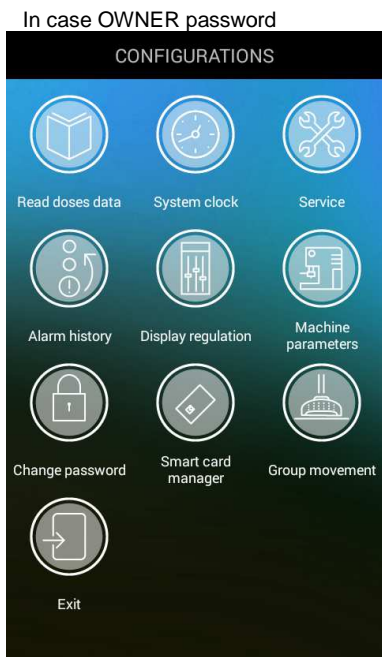

Carimali S.p.A. con socio unico Via Industriale, 1 - 24040 Chignolo d'Isola (BG) - Italia  
T: +39 035 4949555 F: +39 035 905447  
www.carimali.com – service@carimali.com